

### Features:

- Stage monitors, side-fill and P.A. applications.
- Compact size.
- Plastic bi-radial horn.
- 25 mm (1") throat.
- 60°(H) x 40°(V) nominal coverage.



### SPECIFICATIONS

|  |                    |
|--|--------------------|
| Nominal coverage                                 |                    |
| Horizontal .....                                 | 60 degrees         |
| Vertical .....                                   | 40 degrees         |
| Directivity                                      |                    |
| Directivity factor (Q) .....                     | 18                 |
| Directivity index (Di) .....                     | 13 dB              |
| Sensitivity                                      |                    |
| On driver, 1W @ 1m, on axis <sup>1</sup> .....   | 105 dB SPL         |
| Frequency response @ -10 dB <sup>2</sup> .....   | 1,500 to 20,000 Hz |
| Throat diameter .....                            | 25 (1) mm (in)     |
| Minimum recommended crossover <sup>3</sup> ..... | 1,500 Hz           |

<sup>1</sup> Measured with DH200E driver, 1,500 - 8,000 Hz average.

<sup>2</sup> Measured with DH200E driver.

<sup>3</sup> With DH200E driver.

### ADDITIONAL INFORMATION

|  |   |
|--|---|
| Horn material .....                      | PP plastic                              |
| Horn finish .....                        | Black                                   |
| Overall dimensions                       |   |
| Mouth height .....                       | 145 (5.71) mm (in)                      |
| Mouth width .....                        | 160 (6.30) mm (in)                      |
| Length .....                             | 103 (4.06) mm (in)                      |
| Volume displaced by horn .....           | 0.2 (0.007) l (ft <sup>3</sup> )        |
| Net weight (1 piece) .....               | 150 (0.33) g (lb)                       |
| Gross weight (6 pieces per carton) ..... | 1,280 (2.82) g (lb)                     |
| Carton dimensions (W x D x H) .....      | 31 x 23 x 19 (12.2 x 9.1 x 7.5) cm (in) |

### MOUNTING INFORMATION

|  |   |
|--|---|
| Mechanical connection of driver .....  | Screw-on 1 <sup>3</sup> / <sub>8</sub> " - 18 TPI |
| Baffle cutout dimensions (front mount) |   |
| Horizontal .....                       | 115 (4.53) mm (in)                                |
| Vertical .....                         | 115 (4.53) mm (in)                                |

### HORN x DRIVER CONNECTION

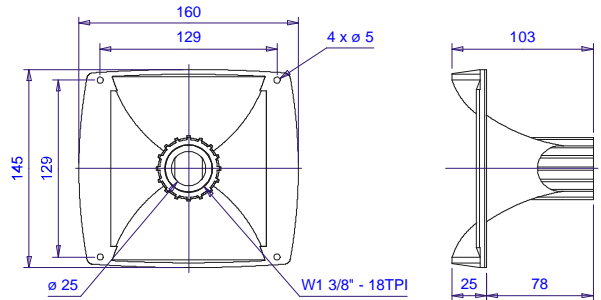
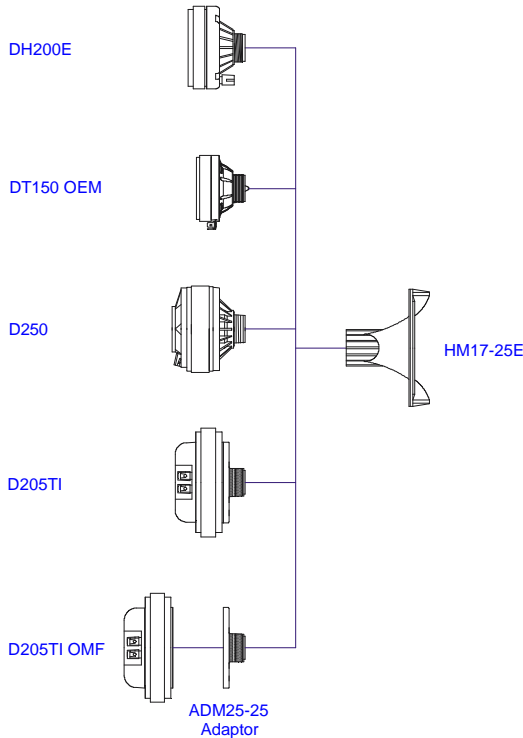

Dimensions in mm.

### RESPONSE AND IMPEDANCE CURVES W/ DH200E DRIVER INSIDE AN ANECHOIC CHAMBER, 1 W / 1 m

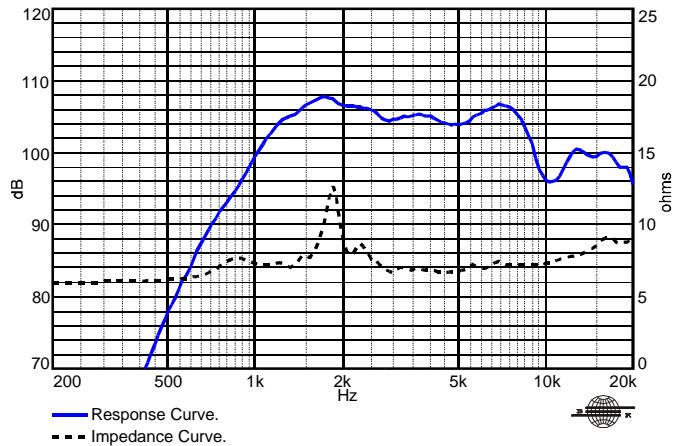

### POLAR RESPONSE CURVE

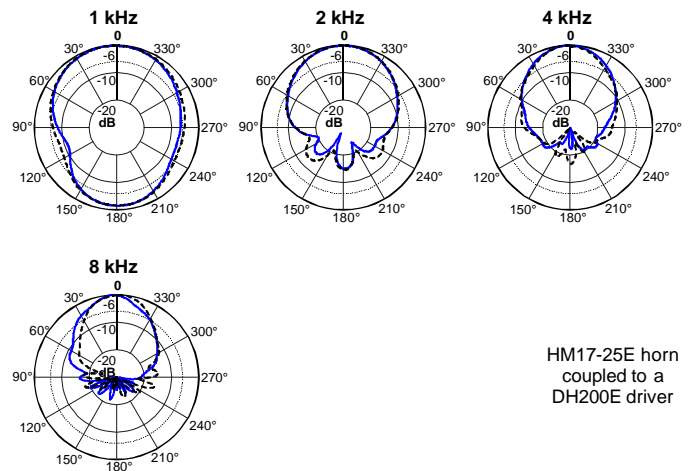

HM17-25E horn coupled to a DH200E driver

— Polar Response Curve, Horizontal.  
- - - Polar Response Curve, Vertical.